

GROUP 52A

INTERIOR

CONTENTS

GENERAL DESCRIPTION	52A-2	FRONT SEAT	52A-6
		REAR SEAT	52A-9
INSTRUMENT PANEL AND FLOOR CONSOLE	52A-3	SEAT BELT	52A-10
ACCESSORIES	52A-4	TRIMS	52A-11
		INTERIOR TRIMS	52A-11
INSIDE REAR VIEW MIRROR	52A-5	DOOR TRIM	52A-12
SEAT	52A-6	ENERGY ABSORBER	52A-13

GENERAL DESCRIPTION

M2520000100559

The interior design, represented by the advanced instrument panel in curve-based styling with fresh image and the combination meter with blue LED illumination.

FEATURES**Quality improvements**

- Instrument panel
- Genuine leather seats <Some models>
- Full interior trim

For the optimum driving position

- Lumbar support (driver's seat)
- Front seats with spring construction
- Dual height adjustment <Some models>
- Adjustable seat belt shoulder anchor (front seat belt)

Safety improvements

- Reflector (front door trim)
- Lower anchorage (rear seat)
- ELR three-point seat belt with a pre-tensioner and force limiter mechanism (driver's side)
- ELR/child seat fastening mechanism (ALR) switching three-point seat belt with a pre-tensioner and force limiter mechanism (front passenger's side)

- ELR/child seat fastening mechanism (ALR) switching three-point seat belt (rear)
- Energy absorber (headlining)
- Use of nonflammable materials (instrument panel, floor console, trim, etc.)

ALR: Automatic locking retractor

Usability improvements

- Armrest
- Vanity mirror with lighting
- Coat hanger (rear pillar trim)
- Power seat (driver's seat) <Some models>
- Heated seat (front) <Some models>
- Door grip (front door trim)

Convenience boxes

- Glove box
- Console box
- Coin holder
- Cup holder
- Pen and note pad holder
- Door pocket

Measures for resource recycling

- Material codes are stamped on resin parts.
- Recyclable materials (polypropylene) are used.

INSTRUMENT PANEL AND FLOOR CONSOLE

M2520001000436

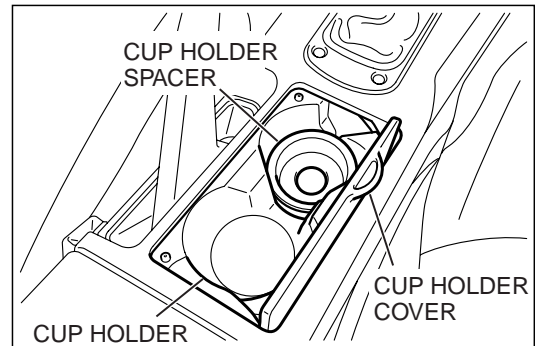
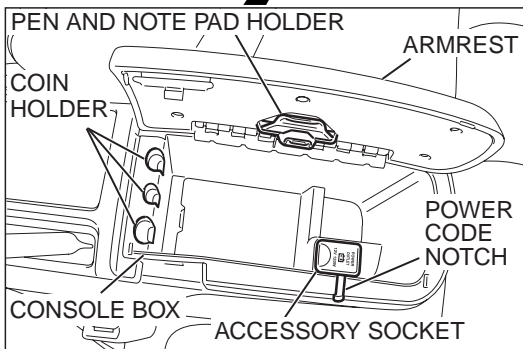
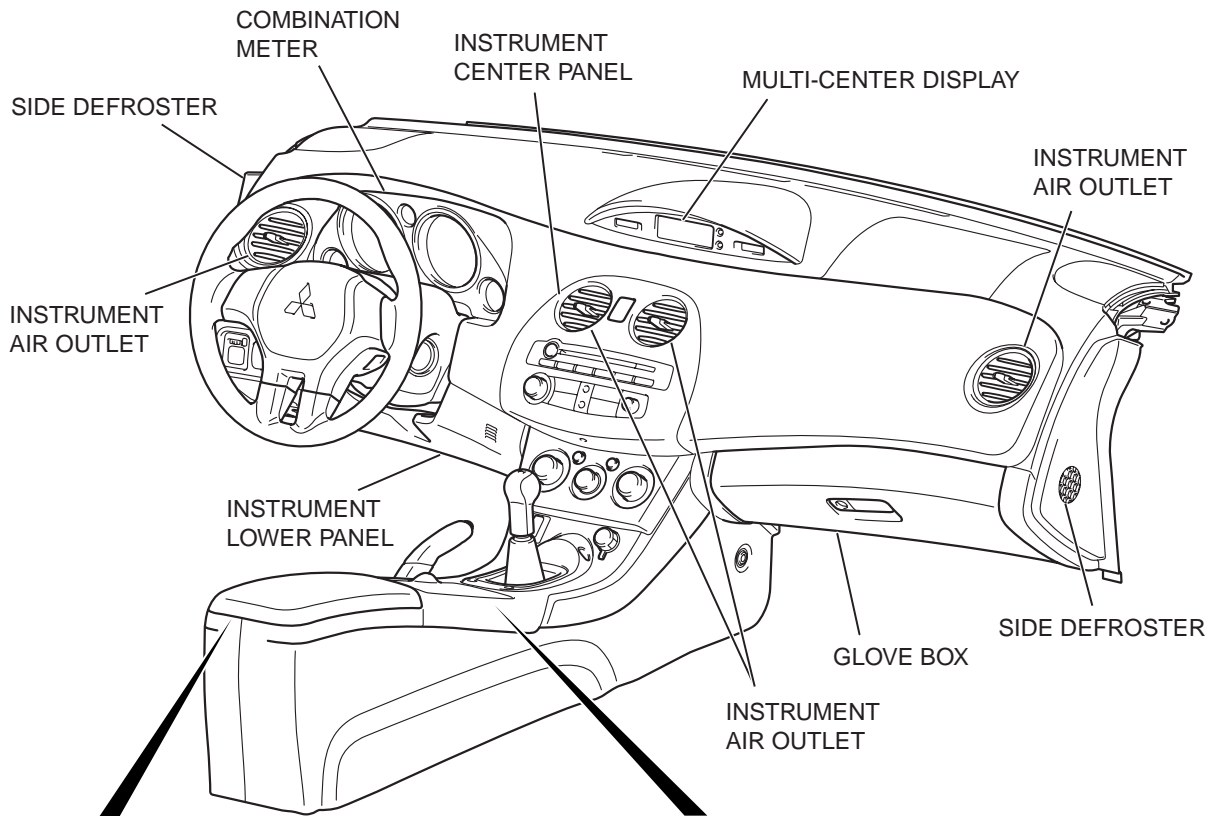

AC405615AB

The instrument panel and floor console have the following features:

- Arch-shaped pad at the instrument panel improves surface quality. Three color variations are available for the pad.
- Silver coating has been applied to the circumferences of the combination meter, instrument center panel, and instrument air outlets.
- Chrome plating is on the air outlet knobs.
- The upper edges of the glove box and instrument lower panel have been concealed with the arch-shaped pad. The structure prevents any gaps from being exposed.
- The design of the instrument panel has been modified to achieve a clean and neat impression by moving the side defroster duct to the door trim, and by not exposing the front defroster nozzles.
- A damper mechanism is in the glove box.
- A lamp is inside the glove box.
- A light at the bottom of the instrument center panel illuminates around the floor console.
- Using blue LEDs, the night illumination color for the audio units and instrument panel switches are ice blue.
- The Multi-center display is on the same level as its surroundings.
- The multi-center display is aligned with the top of the instrument panel for improved visibility of the audio display and other controls.
- Unique audio control panel matches the design of the instrument center panel, providing a smooth center surface. Silver-colored CD slot area.
- Touch-type audio switches are used and the gap around the switches is reduced.

- One removable cup holder spacer, which two different-size cups can be held, has been installed to the floor console.
- A closable cover has been attached to the cup holder on the floor console to improve practicability.
- The floor console box holds 9 CD's with case, cell phone, pen and note pad holder, two folding maps, power cord notch for easy access when armrest lid is closed, coin holders (8 quarters, 12 dimes and 8 nickels), and the battery direct accessory socket. This provides a large storage capacity.
- The arm rest can be opened and closed easily from the driver's side.

ACCESSORIES

M2520002000138

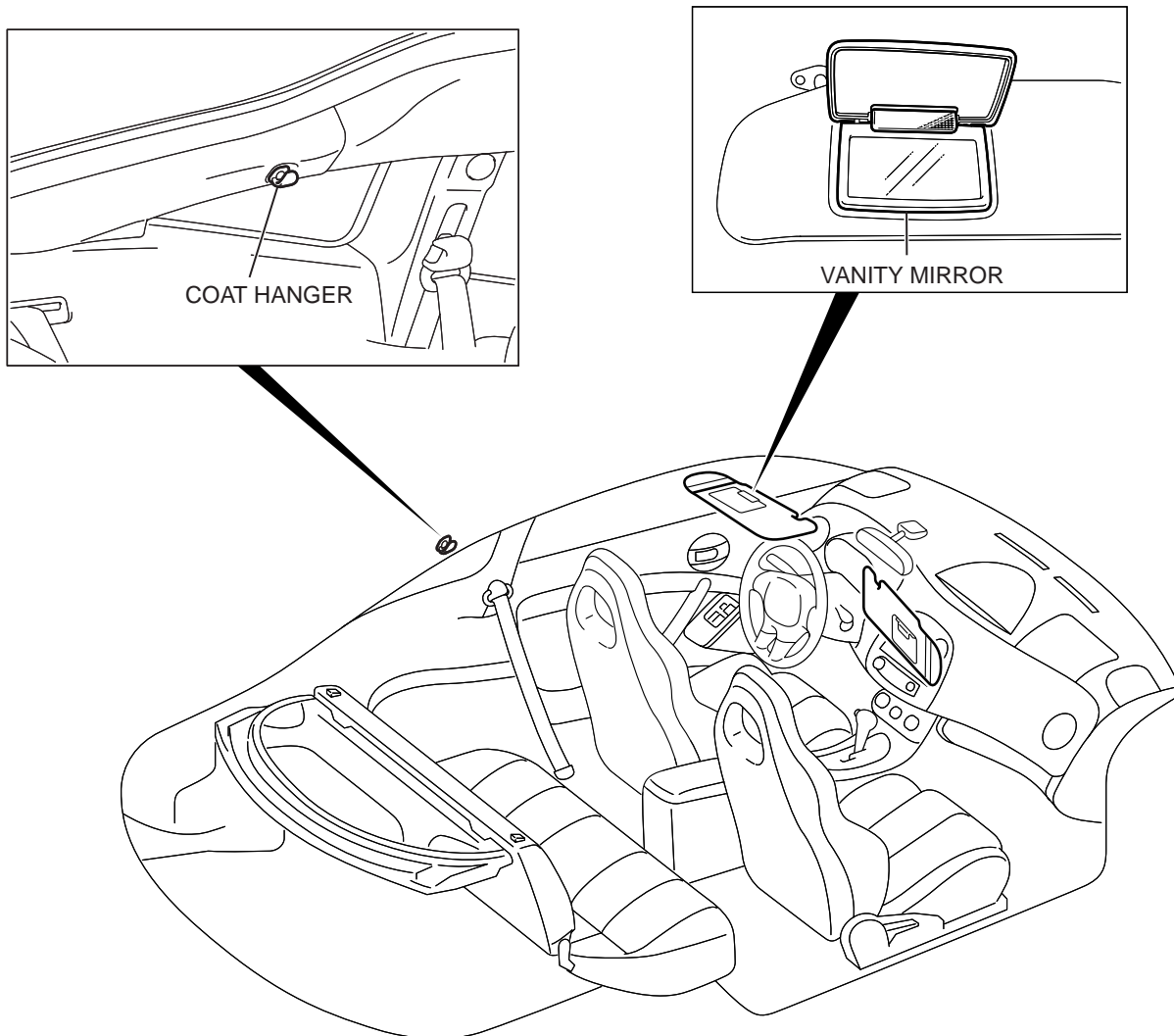

- Vanity mirror with illumination function is in the sun visor .
- Coat hanger is attached to the rear pillar trim .

AC407033AB

INSIDE REAR VIEW MIRROR

M2520000900016

AUTOMATIC ANTI-GLARE MIRROR

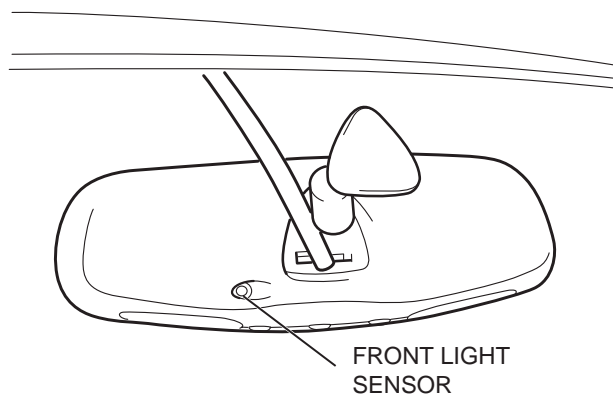
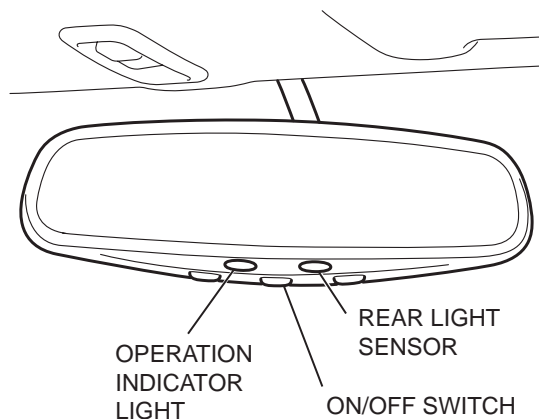

AC406413AB

Some models have an automatic anti-glare inside rear view mirror, which changes the reflectance of a mirror automatically depending on the outside brightness.

- The automatic anti-glare inside rear view mirror incorporates a front light detection sensor, rear light detection sensor, and control unit. The front light detection sensor detects the outside brightness, and the rear light detection sensor detects the brightness of headlights coming from behind. Depending on the difference of the quantity of light, the quantity of reflection is controlled to reduce glare from behind.

- When the vehicle is moving backward, the anti-glare function is deactivated to secure a clear rear view.
- This system has an ON/OFF switch.

SEAT

FRONT SEAT

M2520004000509

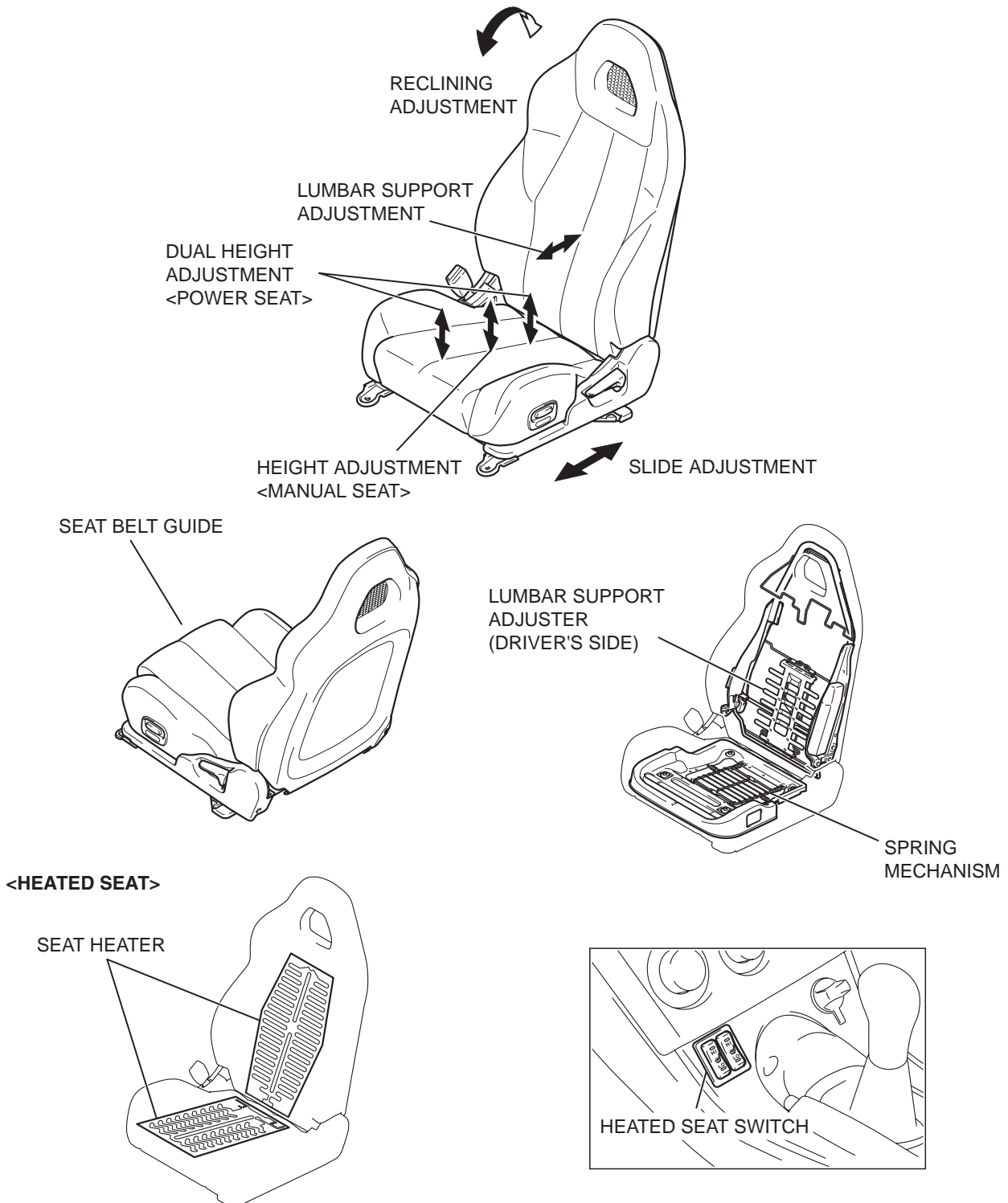

AC406725AB

The front seats are either manual seats or power seats <Some models>. These seats offer the following advantages:

- Blue LED illumination at the heated seat switch.
- The seats are adjustable in the reclining and sliding directions.

- Spring construction makes the seat cushions and seatbacks more comfortable.
- Genuine leather is used for the seats. <Power seats>
- Driver and front passenger seat heaters are available. <Option>

- For the driver's seat, a large lumbar support adjusts smoothly for better riding comfort and improved posture.
- Dual-height adjustment provides optimal driving. <Power seats>
 - Height adjustment enables the optimal driving. <Manual seats>

SPECIFICATIONS FOR HEATED SEAT

ITEM		SPECIFICATION
Energy consumption W	HIGH	75 ± 7.5
	LOW	19 ± 1.9
Thermostat °C	ON → OFF	40 ± 4
	OFF → ON	30 ± 5

HEATED SEAT SYSTEM CIRCUIT DIAGRAM

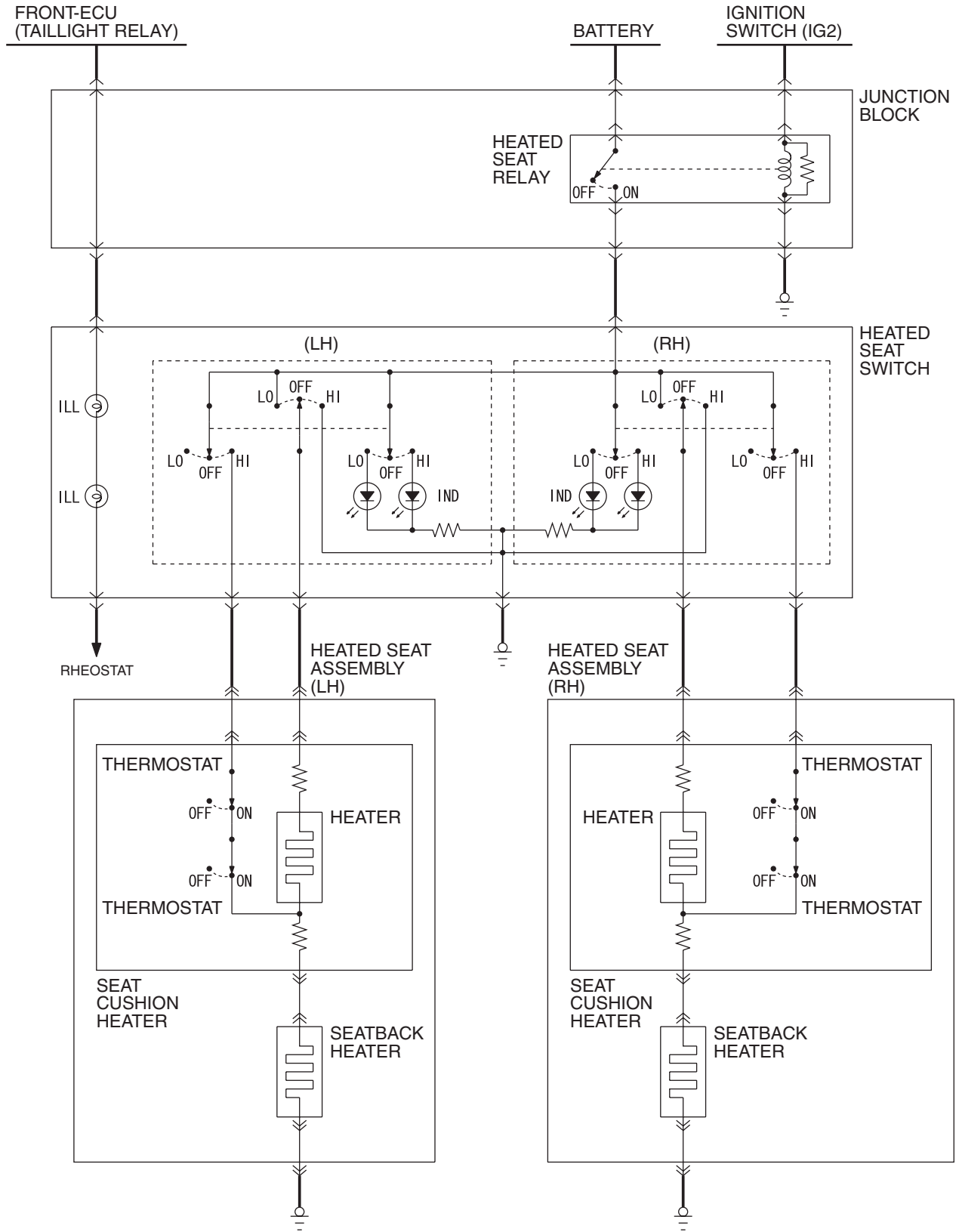

REAR SEAT

M2520007000393

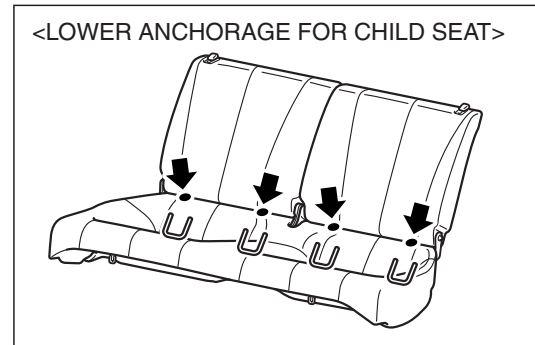
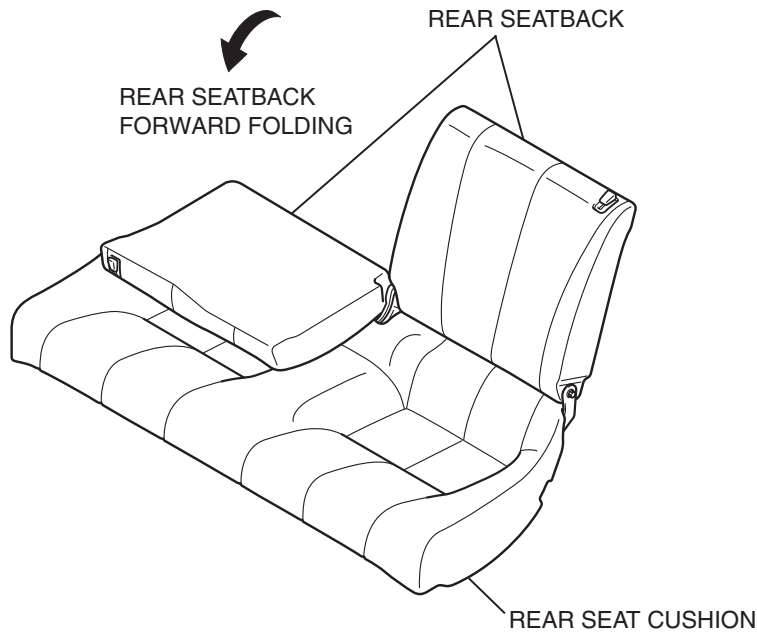

AC407034 AB

The rear seats are configured in a split seat. The rear seats offer the following advantages.

- The right and left seatbacks can be folded forward separately to improve convenience.

- Lower anchorage points and tether anchors are used for attachment of a child seat in compliance with FMVSS225/CMVSS210 safety codes. In the seat assembly, the lower anchorage points are arranged so that they are accessible through the slips on seat cushion for a more attractive appearance when not in use.

SEAT BELT

M2520010000348

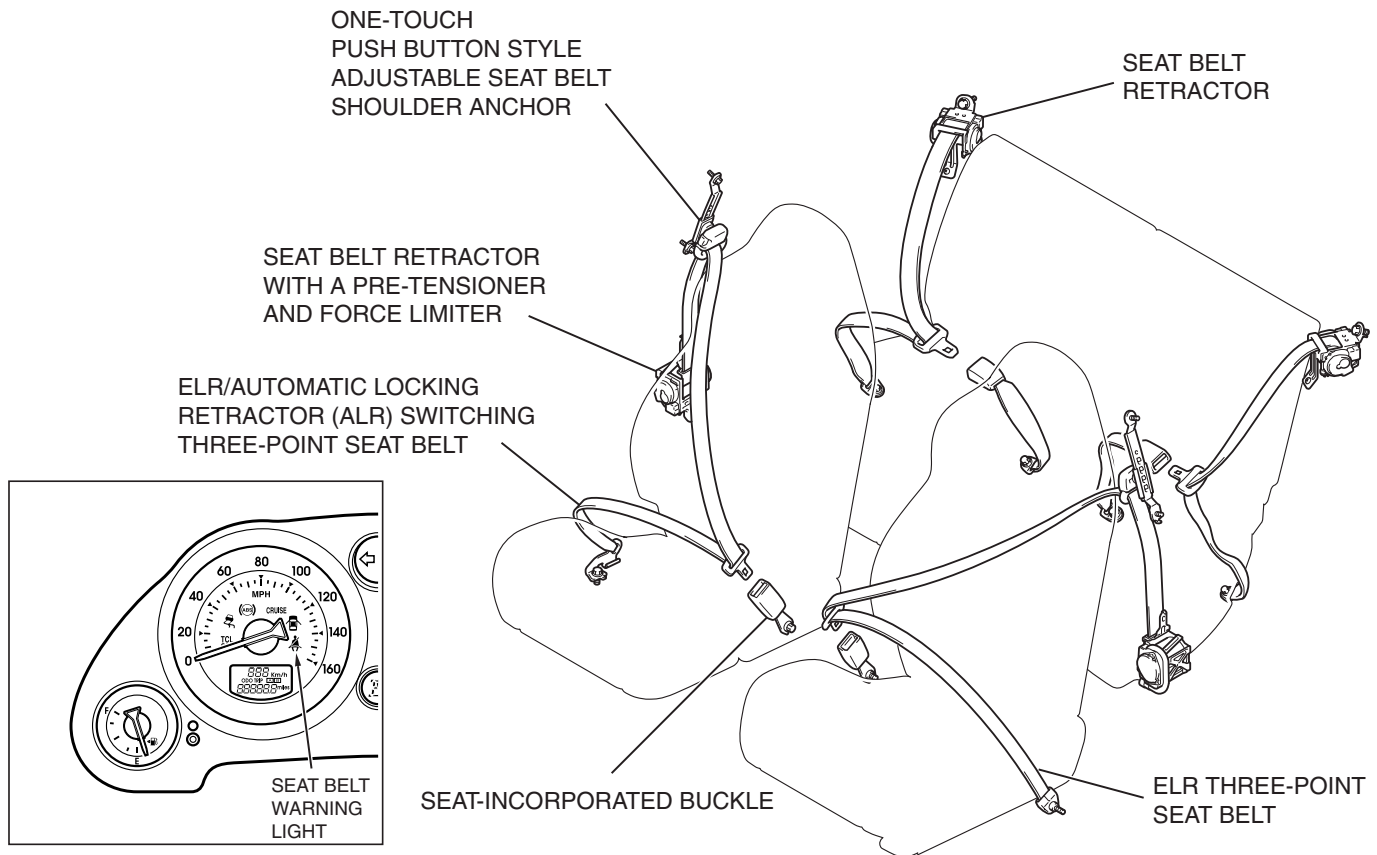

AC406146AB

<FRONT SEAT BELT>

- One-touch push button style adjustable seat belt anchors and seat-incorporated buckles ensure optimum belt fitting and placement.
- ELR three-point seat belt is used for the driver's seat.
- ELR three-point/child seat fixing mechanism (ALR) switching seat belt is used for the passenger's seat to improve safety.
- Seat belt retractor has a pre-tensioner force limiter.

- The combination meter has a seat belt warning light to prompt the driver to wear the seat belt.

<REAR SEAT BELT>

- ELR three-point/child seat fixing mechanism (ALR) seat belt improves safety.

SEAT BELT RETRACTOR WITH FORCE LIMITER

The driver's/front passenger's seat belt retractor has been equipped with a force limiter. The force limiter is a device which operates when a predetermined force is applied, and limits the force.

OPERATION

1. If a collision energy is transmitted to the seat belt, the ELR mechanism will operate to lock the seat belt.

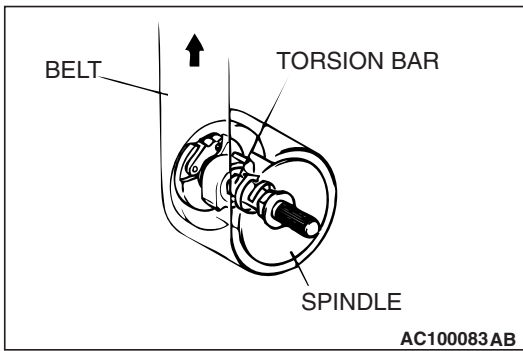

2. Then, if the energy increases to a predetermined value, the torsion bar will be distorted. As the spindle rotates together with the torsion bar, the seat belt webbing is pulled out, reducing the impact against the occupants.

TRIMS

INTERIOR TRIMS

M2520012000292

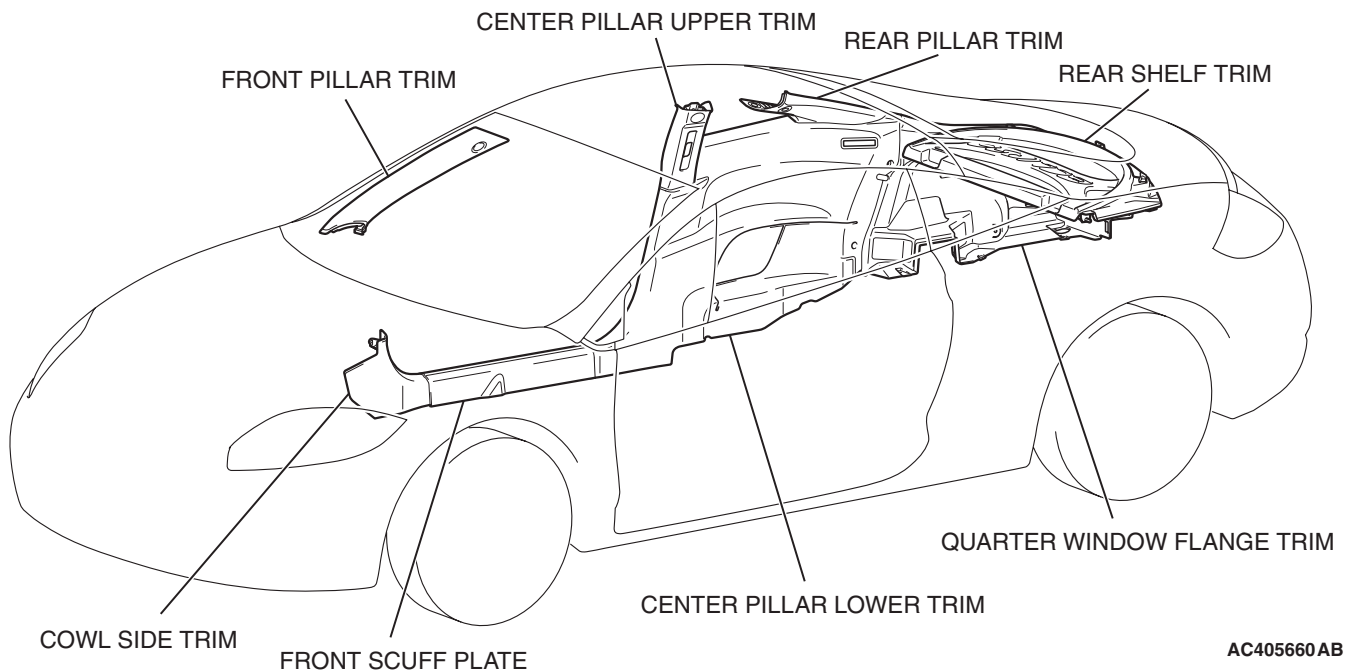
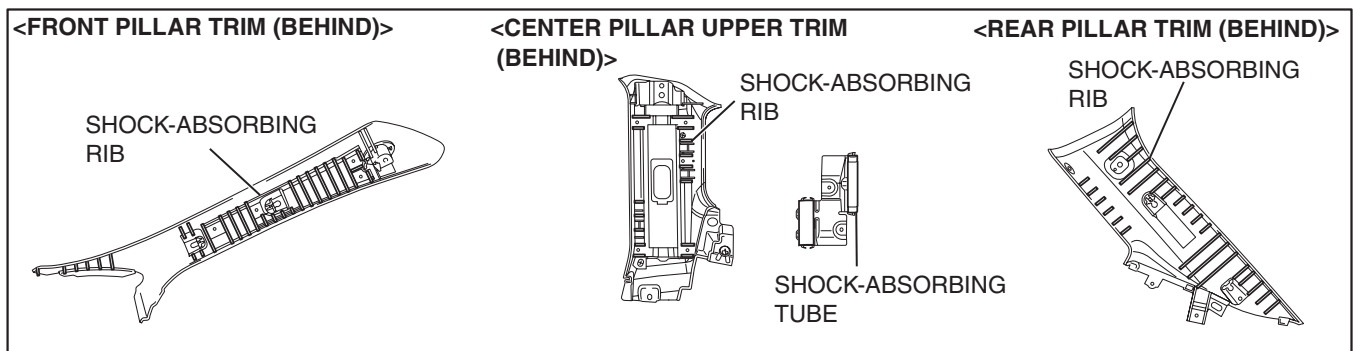

AC405660AB

- Shock-absorbing ribs have been used in the front pillar trim, center pillar upper trim and rear pillar trim to protect the heads of occupants in the event of a side collision, and a hard resin material improves safety.
- Material codes are shown on trim for recycling.
- Coat hangers are on the rear pillar trims on the driver's and passenger's sides.

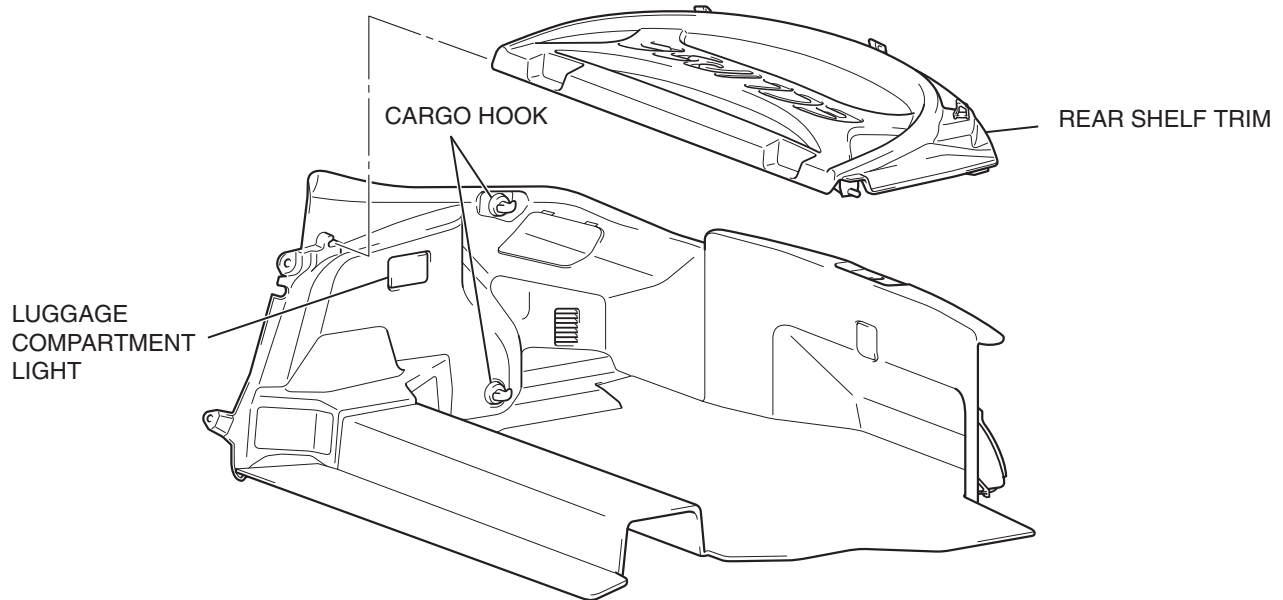

AC406155AB

- Cargo hooks are on attached to the upper and lower parts of the cargo side trims on both sides.
- A luggage compartment light is on the cargo side trim on the right side at the position where the whole compartment can be illuminated.
- Resin rear shelf trim has the ECLIPSE logo.

DOOR TRIM

M2520012300301

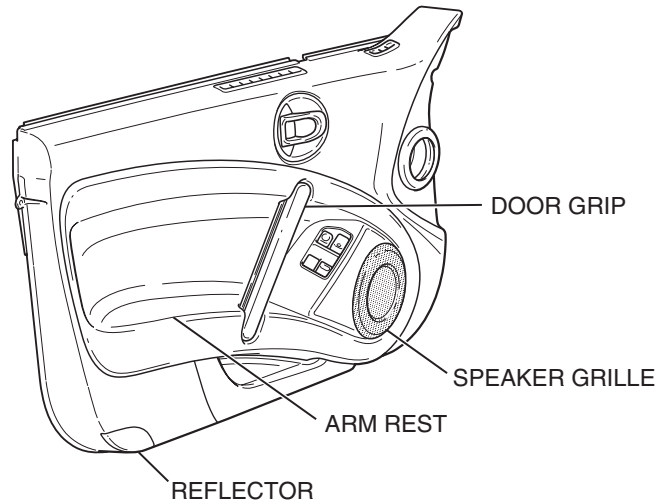

AC405653AB

- The speaker panel and power window switch panel have been integrated, and the high-grade speaker grille is fully painted in silver.
- Reflector is at the rear end of the door trim.
- Large door grip with solid look.
- Armrests provide ample space to rest an elbow. Polyvinyl chloride vinyl is used on the surface to provide soft contact.

ENERGY ABSORBER

M252000600037

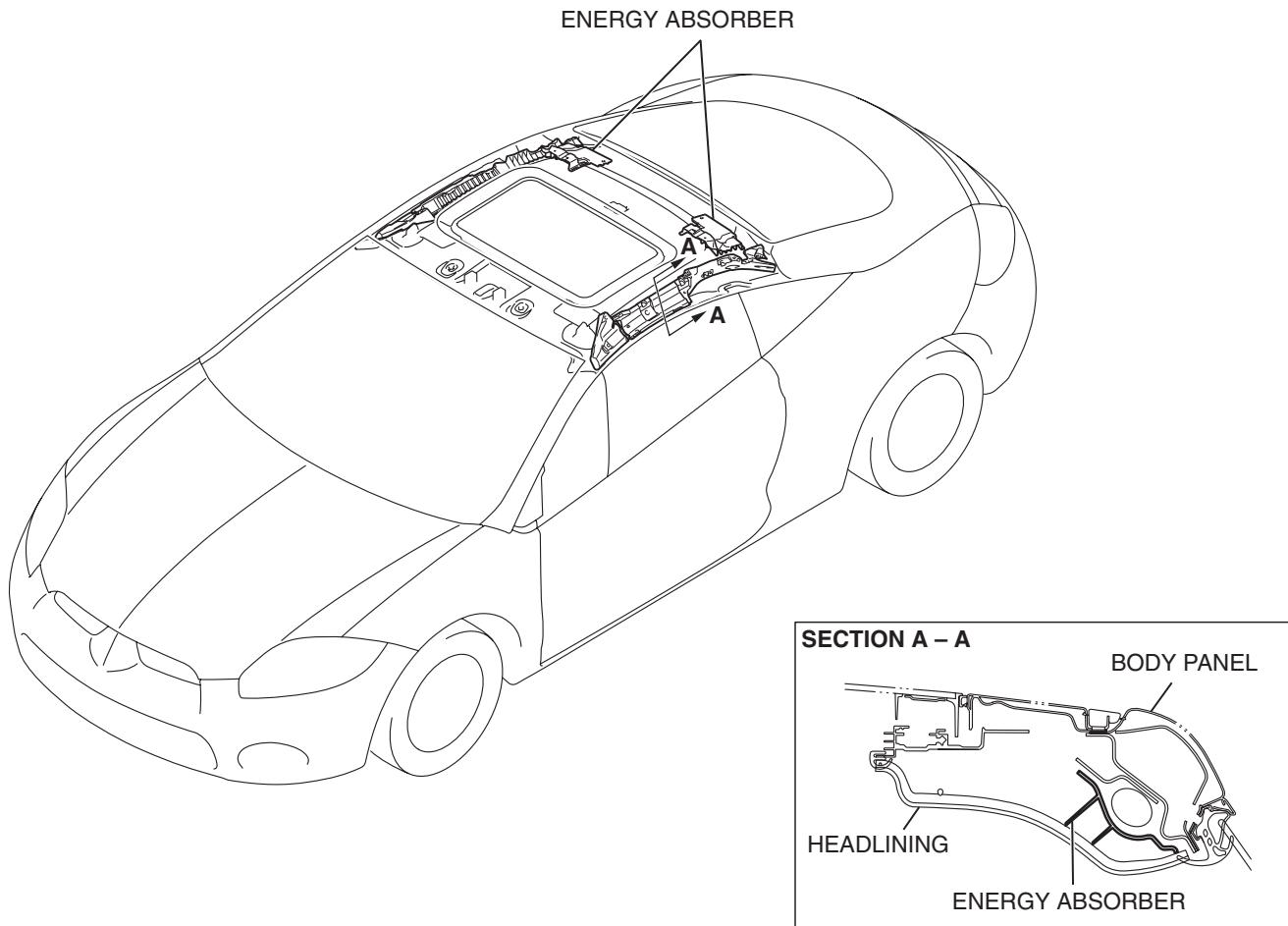

AC407126 AB

Energy absorber has been installed on the reverse side of the headlining. In case of impact, the energy absorber is deformed by a head of an occupant before the head hits the body panel, reducing the impact.

NOTES