GROUP 5

**SYNTHETIC-RESIN
PARTS**

CONTENTS

**LOCATION OF SYNTHETIC-RESIN
PARTS 5-2**

LOCATION OF SYNTHETIC-RESIN PARTS

M4050001000537

The location and material of each of the principal synthetic-resin parts are shown below.

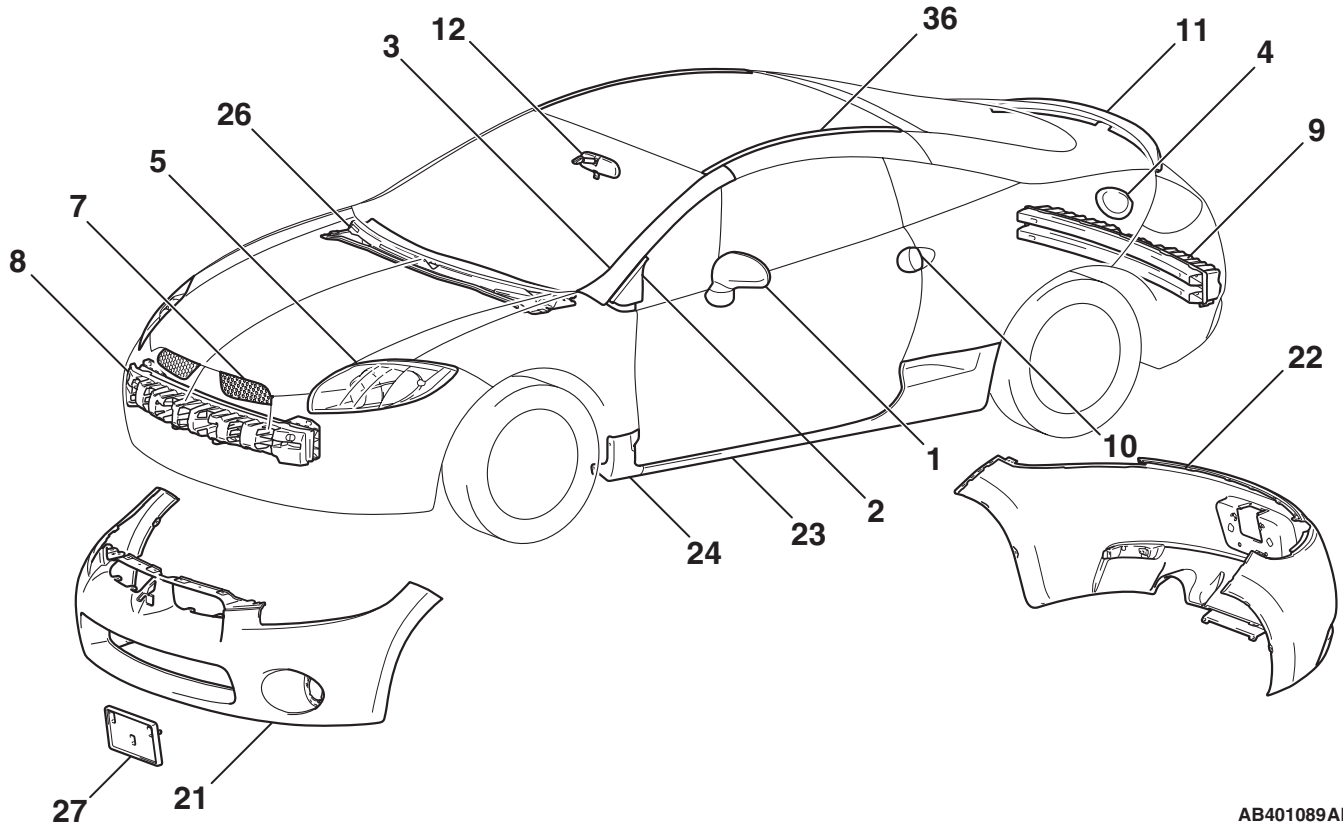

AB401089AB

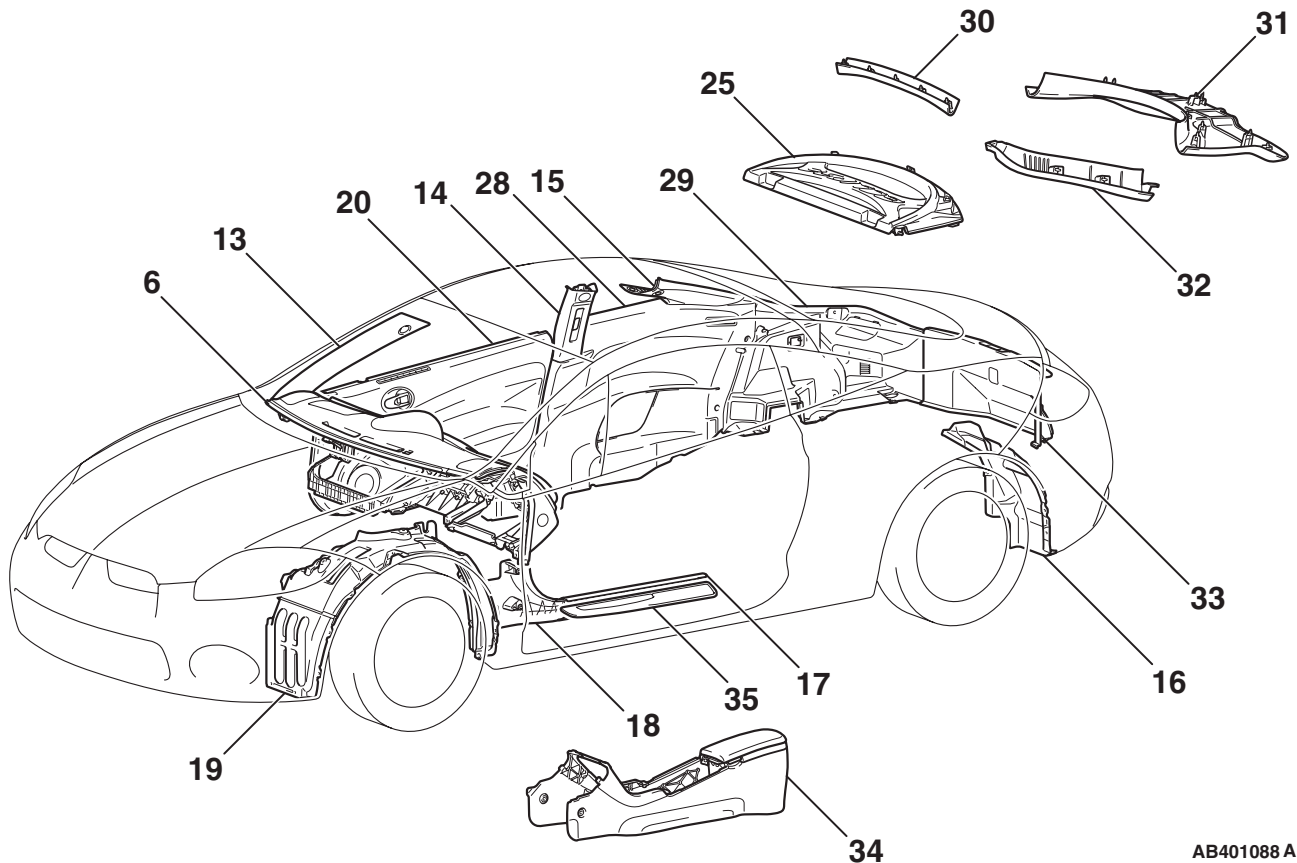

AB401088 AB

**SYNTHETIC-RESIN PARTS
LOCATION OF SYNTHETIC-RESIN PARTS**

NO.	PART NAME	NAME OF RESIN	ABBREVIATION	HEAT-WITHSTAND TEMP [° C (° F)]
1	Door mirror	Acrylonitrile butadiene styrene	ABS	80 –110 (176 – 230)
2	Delta garnish outer	Acrylonitrile styrene acrylate	ASA	90 (194)
3	Front pillar garnish	Glass reinforced and mineral filled polyamid 6	PA6-(GF15+MD26)	80 (176)
4	Fuel filler lid	Mineral filled polyamid 6(40%)	PA6- M40	80 (176)
5	Headlight	Polycarbonate	PC	130 –140 (266 – 284)
6	Instrument panel	Polycarbonate and Acrylonitrile butadiene styrene	PC+ABS	120 –125 (248 – 257)
7	Radiator grille	Polymer alloy of polycarbonate and acrylonitrile-styrene-acrylate	PC+ASA	100 (212)
8	Front bumper core	Polycarbonate and Polybutylene terephthalate	PC+PBT	140 –150 (284 – 302)
9	Rear bumper core			
10	Front door outside handle			
11	High-mounted stoplight	Poly(methyl methacrylate)	PMMA	80 –100 (176 – 212)
12	Inside rear view mirror	Polypropylene	PP	80 –120 (176 – 248)
13	Front pillar trim			
14	Center pillar trim			
15	Rear pillar trim			
16	Rear splash shield			
17	Scuff plate inner			
18	Cowl side trim			
19	Front splash shield			
20	Front door lower trim	Polypropylene, polyvinyl chloride	PP/PVC	80 (176)
21	Front bumper face	Talc filled rubber modified polypropylene	PP+E/P-TD	80 (176)
22	Rear bumper face			
23	Side air dam rear	Talc filled rubber modified polypropylene (20%)	PP+E/P-TD20	110 (230)
24	Side air dam front			
25	Rear shelf trim	Talc filled polypropylene(15%)	PP-TD15	110 (230)

NO.	PART NAME	NAME OF RESIN	ABBREVIATION	HEAT-WITHSTAND TEMP [° C (° F)]
26	Front deck garnish	Talc filled polypropylene (20%)	PP-TD20	120 –130 (248 – 266)
27	Front license plate garnish			
28	Rear side trim			
29	Quarter lower trim			
30	Lift gate trim upper center			
31	Lift gate trim lower			
32	Lift gate trim upper side			
33	Rear end trim			
34	Floor console			
35	Scuff plate outer	Talc filled polypropylene (26%)	PP-TD26	90 (194)
36	Drip molding	Polyvinyl chloride	PVC	80 (176)

NOTE:

- If the material symbols designated by the ISO differ from the old symbols, both are given, with the old symboling enclosed in brackets.
ISO: International Standardization Organization.
- A slash (/) in the material symbol indicates that two different materials make two-layer construction. A plus sign (+) indicates that the two different materials mix each other.
- The indicated heat-withstand temperature for parts which are composed of two or more types of material is the value for the material with the lowest heat-withstand temperature.
- The material symbols for synthetic-resin parts are embossed on the parts in hidden places.